



Product 527840



527840 Active holder for fixed installation 2A charger. Adjustable holder. Fits for devices with and without skin with the following dimensions: Width: 62-77 mm, Thickness: 6-10 mm. With USB Type C charging cable.

Keep your phone in a holder when on the road and you will always have it within easy sight and reach. The active holder for fixed installation is to be connected inside the dashboard, this gives a discreet, neat installation without cables hanging over the interior! This holder comes with a USB Type C charging cable. Fits phones with USB Type C charging inlet only.

The adjustable holder fits for devices with and without skin with the following dimensions: Width: 62-77 mm, Thickness: 6-10 mm. Adjustable holders come in various sizes. Measure your device and compare with the holder specifications in order to make sure you have chosen the correct product (if you are using a skin: measure the device with the skin in place). Before using the holder you need to set the holder's width so it suits your device, then your phone is held firmly in place in an upright position for maximum cellular reception. The holder has a neat and discreet design which blends well with the vehicle's interior.

12 Volt. The product is E-approved. Connect the power cable with a 2A fuse. 2A charger, professional installation recommended.

The holder is made of black ABS plastic. It is easy to put the device into the holder, and just as easy to take it with you when leaving the vehicle. The holder is equipped with a tilt swivel so you can adjust the angle of your device in order to avoid light reflection on the screen. You can tilt the holder 22° in each direction. Attach onto ProClip Mounting Platform.

This product supports Qualcomm QC 2.0 quick charge (provided the device supports Qualcomm QC 2.0 quick charge).

EAN: 7320285278400

INSTALLATION INSTRUCTIONS

1.

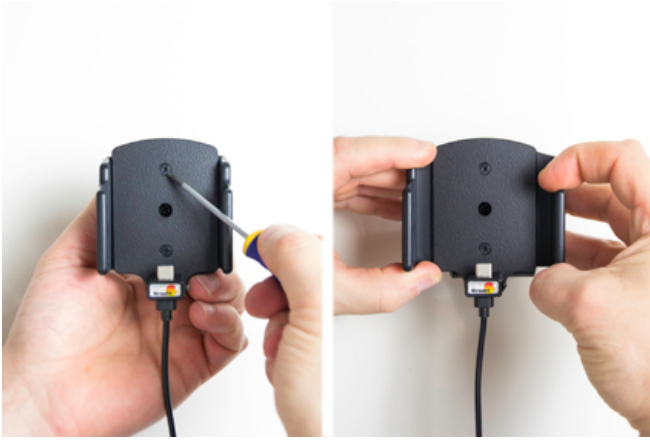

2.



3.



4.



Read all of the instructions before attaching the holder. Important Note: Connect to a 2 A fuse holder and fuse inline with the Red wire close to the power source. Ensure the charger unit is securely mounted behind the dashboard in a well ventilated area! Route the power cable from the charger unit to the power supply source in the vehicle and connect as follows: 1. Connect the White wire to a Negative Ground connection of the vehicle or the vehicle chassis. 2. Connect the Red wire to a 12/24 Volt power supply in the vehicle that is controlled by the ignition switch of the vehicle. How to mount the holder: 1. To adjust the holder for your device: Loosen the screws on the front side of the holder, so the sides of the holders can be adjusted. 2. Place the device in the holder and press the sides together so the device is firmly in place. Adjust the positioning of the charging connector so it connects properly to the phone. Lock the charging connector into position by screwing the screw into the hole on the side of the charging connector block. Remove the device carefully. Tighten the screws on the front side of the holder. 3. To install the holder: Loosen the screw in the center of the holder so you can remove the tilt swivel attaching plate on the back. Place the attaching plate onto the desired position. Screw the attaching plate into place with the enclosed screws. Place the holder over the attaching plate so the screw fits in the hole in the tilt swivel. Screw a few turns on the screw, just so the thread starts to pull. Pull the holder toward you and hold it slightly tensed, in the same time tighten the screw so the holder is pulled toward the tilt swivel. Tighten the screw firm at first, then loosen it a bit so the holder is firmly in place, but still can be adjusted. 4. The holder is in place.
